

Y 型水过滤器 Y water filter

过滤器是一种用于清除过滤水中机械杂质的产品，可用于热水采暖、制冷空调系统及其它各类 生产工艺设备的冷热水管或者耐酸等腐蚀性介质管路上除污。尤其适用于安装在风机盘管机组的进 出口处，以保护设备免受杂质的冲刷、磨损、淤积和堵塞，保证设备的正常运行，延长设备的使用 寿命。本产品执行标准为 GB/T1 4382-2008《管道用三通过滤器》。

本过滤器系列产品由铸铁、铸钢、黄铜、不锈钢等材质制成，具有体形小、安装方便、坚固耐 用。过滤网采用 20-80 目不锈钢丝网、滤网面积大、阻力小、除污能力强、清洗滤网间隔时间长、 清污方便，不需装旁通管，可不定期进行清洗，清洗时紧闭前后阀门，抽出滤芯，去掉杂质复位即 可。

Y 型过滤器工作压力为 1.6MPa，试验压力为工作压力的 1.5 倍。

This type of products is used to clear up mechanical impurity in water through filtering, it can eliminate dirt coated on cold or hot water pipe and anti-erosion pipe in hot water heating system, air-conditioning refrigeration system and other process equipments. It is specially suitable to install on the inlet and outlet of the fan engine coiled pipes, protect equipments from washing out, abrading, depositing and jamming caused by the impurity. It can ensure the smoothly run of the equipment, and prolong the working longevity of the equipment. The product standard is GB/T14382-2008《Three-pass filter for pipes》.

The water filter is made of cast iron, cast steel, brass and stainless steel with small figure. It is indurate and easy to install. Adopting stainless steel filter meshwork, it has large filter area, low resistance, strong decontaminate effect, long spacing time of washing filter meshwork, and it is easy to clear up aperiodically by closing valves back and front, drawing out filter core, getting ride of the impurity and replacing, while the side pipeline is unnecessary.

Working pressure of Y water filter is 1.6Mpa, testing pressure is 1.5 times of the working pressure.

产品简图： Sketch:

Y-15-50 螺纹连接过滤器尺寸表

Dimension table of filter connected by screw

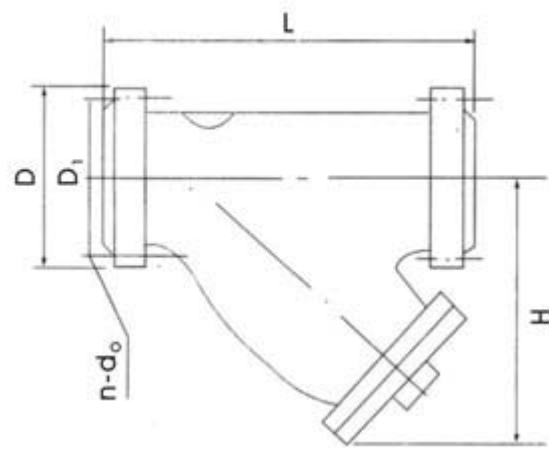

公称通径 DN diameter of nominal	螺纹连接 specification of the connecting screw	铜质 Copper		铸铁 Iron	
		长 Length	高 Highness	长 Length	高 Highness
15	ZG 1/2	70	55	90	60
20	ZG 3/4	90	65	105	75
25	ZG 1	100	75	125	85
32	ZG 1 1/4	115	86	140	97
40	ZG 1 1/2	130	97	160	110
50	ZG 2	150	110	180	130

Y-15-500 法兰连接铸铁、铸钢过滤器尺寸表

Dimension table of cast iron and cast steel filter connected by flange

公称通径 DN diameter of nominal	32	40	50	65	80	100	125	150	200	250	300	350	400	450	500
L	180	190	220	270	290	350	390	440	540	650	800	900	1000	1100	1200
H	170	190	220	290	310	360	430	500	620	650	800	850	900	1000	1100
D	140	150	165	185	200	220	250	285	340	405	460	520	580	640	715
D ₁	100	110	125	145	160	180	210	240	295	355	410	470	525	585	650
n	4	4	4	4	8	8	8	8	12	12	12	16	16	20	20
d ₀	18	18	18	18	18	18	18	22	22	26	25	26	30	30	33