

WHD 型吊式橡胶隔振器

WHD suspending rubber vibration absorber

WHD 型吊式橡胶隔振器是由

金属隔振元件组成，橡胶硬度

分成不同等级以满足不同承载

能力，具有耐油、耐酸碱、耐

高温等性能。该产品阻尼比

大，固有频率低，安装方便，

对固体传声有明显的降噪效

果，主要适用于各种大小设备

及管道的吊装隔振。由于橡胶

载荷范围大，尤其适用于管道

的重量、重心很难精确计算的

场合。已使用于国家大剧院风

管和设备吊装隔振消声。

WHD型简图Sketch:

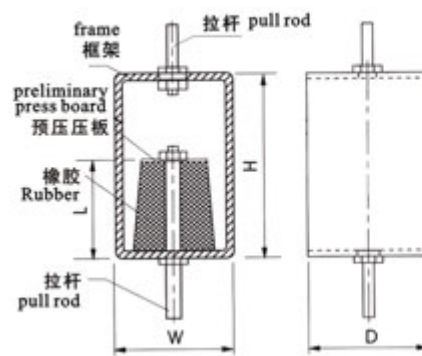

WHD-D型简图Sketch:

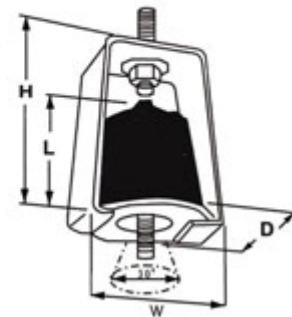

WHD suspending rubber vibration absorber is composed of metal outline border and rubber vibration absorbing components. There are different grades of the rubber's rigidity to meet different loading ability with the capability of resisting to grease, acid, alkali and high temperature. It has large damp ratio and low intrinsic vibration frequency, is convenient to install. It is effective in reducing noises of solid transaudient, is mainly applied for different type of suspending vibration absorbing for large and small equipment and pipelines. It is useful specially when the weight of pipe and center of gravity are hard to be calculated because of the rubber's wide load scope. Have been applied to isolating vibration and reducing noise for air conduit and hoisting equipments in National Grand Theater.

WHD 型吊式橡胶隔振器技术特性表 Technological characteristic table

规格 type	承载范围 N load scope	变形范围 (mm) distortion scope	自振频率 (HZ) intrinsic vibration frequency	H(mm)	D(mm)	W(mm)	L(mm)	丝杆直径 (mm) diameter of the screw
WHD-10	50-150	5-10	10-7	100	50	50	46	M8
WHD-20	100-300	5-10	10-7	100	50	50	46	M8
WHD-30	150-450	5-10	10-7	100	50	50	46	M8
WHD-40	200-600	5.5-10	9.5-7	100	50	50	46	M8
WHD-80	400-1200	5.5-10	9.5-7	100	50	50	46	M12
WHD-160	800-2400	5-10	10-7	100	60	60	46	M12
WHD-320	1600-4800	5-10	10-7	120	80	80	56	M14
WHD-640	3200-9600	5.5-10	9.5-7	120	80	80	56	M16
WHD-1280	6400-19200	5-10	10-7	140	120	120	80	M18
WHD-2560	12800-38400	5.5-10	9.5-7	140	120	120	80	M24

WHD—D 型吊式橡胶隔振器技术特性表 Technological characteristictableVHS 型技术特性表： Technological characteristictable:

规格 type	承载范围 N load scope	变形范围 (mm) distortion scope	自振频率 (HZ) intrinsic vibration frequency	H(mm)	D(mm)	W(mm)	L(mm)	丝杆直径 (mm) diameter of the screw
WHD—D-10	50-150	5-10	10-7	80	40	70	42	M10
WHD—D-20	100-300	5-10	10-7	80	40	70	42	M10
WHD—D-40	200-600	5.5-10	9.5-7	80	40	70	42	M10
WHD—D-80	400-1200	5.5-10	9.5-7	80	40	70	42	M12
WHD—D-160	800-2400	5-10	10-7	105	55	90	56	M12
WHD—D-320	1600-4800	5-10	10-7	105	55	90	56	M14
WHD—D-640	3200-9600	5.5-10	9.5-7	105	55	90	56	M16
WHD—D-1280	6400-19200	5-10	10-7	140	70	120	80	M18
WHD—D-2560	12800-38400	5.5-10	9.5-7	140	70	120	80	M24

WHD-D/40动态测试结果
WHD-D/40 dynamic testing results

f₀=7.91HZ
A=7.8931E-05

